

Where concrete abuts a hard surface, provide a compressible expansion joint

TYPICAL CROSS SECTION

SCALE 1 : 20

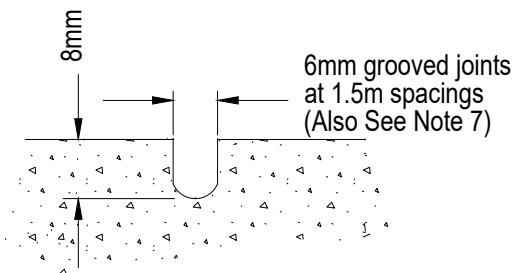

GROOVED JOINT DETAIL

Actual size

Approved expansion jointing material to be full depth of concrete

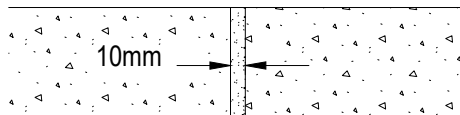

FCR bedding

10mm min. expansion joints to be constructed at max. 9m spacing

EXPANSION JOINT DETAIL

Scale 1 : 5

NOTES:

1. Concrete strength shall be 25Mpa at 28 days.
2. Edge of slabs shall be finished with a suitable edging tool to provide a 40mm smooth border completely around each slab.
3. Concrete work shall have a fine, even, dense steel trowelled surface without blemish, finished surface to be brushed with broom before setting.
4. Where new path abuts existing concrete vehicle crossing, thickness of path to be increased to match crossing for the length of one bay, and the joint shall be dowelled with 12mm bars at 500mm centres, embedded 200mm and placed centrally in the concrete thickness.
5. All footpaths (council works and subdivisions), thickness to be 125mm with SL62 mesh. Concrete footpaths to be constructed with grooved joints at 1.5m centres & expansion joints at 9m centres.
6. Reinstatement of existing concrete footpaths shall be in whole bays only and minimum of 125mm thick.
7. Key Joint (expansion and/or construction) or approved equivalent to be used in place of ruled joints where directed.



SCALE: AS SHOWN

DATE: Dec 2012

APPROVED:

Addy

DRAWN: H.D./P.J.D.

CHECKED: RS

MANAGER ENGINEERING SERVICES

LAST AMENDED:

April 2021

CONCRETE FOOTPATH

SD 330

PAGE 1 OF 1